

# Delta Series Programmable Jackfield System Patchbay

Featuring: AVP Patented **MORPH** Style Modules

- Stellar performance in harsh environments
- Extensively used in mobiles due to proven reliability and compact design
- Jacks rated at 30,000 cycles
- No dip switches
- No ribbon cable
- No excessive connectorization
- Gold-plated programming jumpers

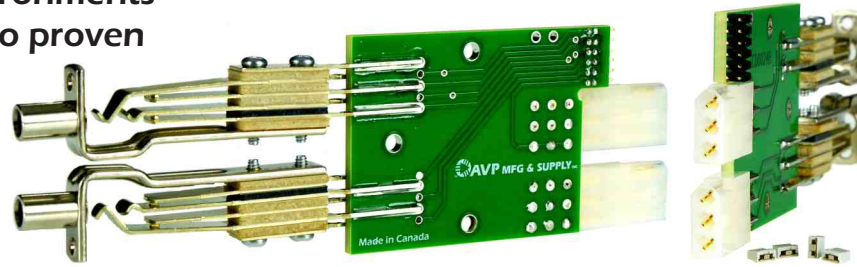

**Programmable Module**  
Available in Longframe & Bantam



2RU Jackfield Frame

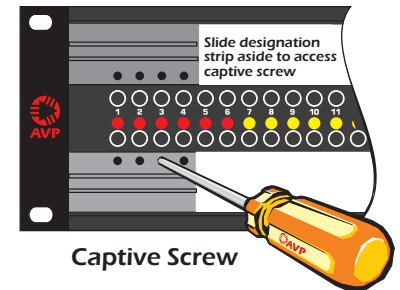

**Panel Features:**

- CIS (Circuit Identification system) allows color-coding of each circuit's function, available in 10 colors
- Maximized designations
- Jackfield shipped with crimp-pin mating connector kit and a captive hex key (where applicable)

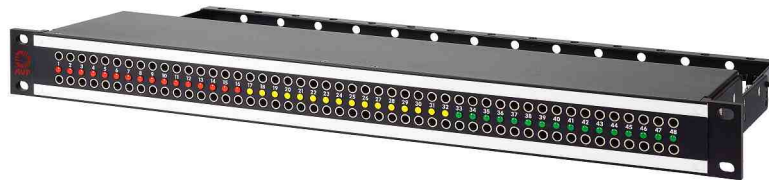

- Available in 1RU, 1.5RU & 2RU
- Bantam and Longframe
- Application: AES/EBU, Analog
- Access Programming Links at rear of panel

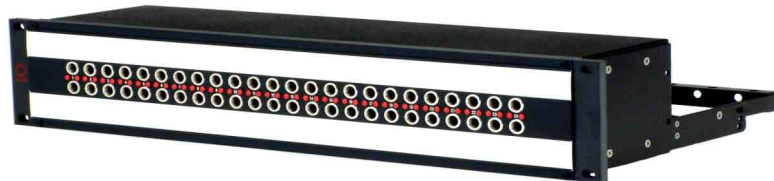

### Programming Options

A TIP	A RING	
B TN	B RN	
A TN	A RN	
A SN	B SN	
A SLV	B SLV	
A BUSS	B BUSS	

<b>A</b>		TIP
		RING
		SLEEVE
<b>B</b>		TIP
		RING
		SLEEVE

Rear View of Module with EDAC 3 pin connector interface (Sleeve = Ground)

- Full Normals
- Half Normals
- No Normals
- Bussed Grounds
- Vertical Grounds
- Switching Grounds version also available



**Studio or Mobile:**  
Morph style modules simplifies system design, saves space, adds flexibility, reliability and reduces weight.